

SUNCOR STAINLESS, INC.

# DECK HARDWARE



## FLAGPOLE CLEAT 304 STAINLESS STEEL



ITEM	A	B	C	Fastener	WT
	(size)				(lb)
S3103-0000	2-1/2"	0.17"	0.50"	# 8 Screws	0.03
S3104-0000	4-1/2"	0.22"	0.81"	#10 Screws	0.09

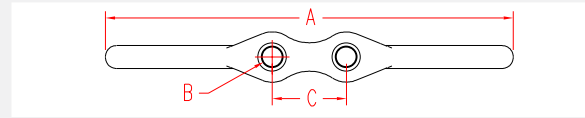

## HERRESHOFF CLEAT 316 STAINLESS STEEL



ITEM	A	B	C	D	Fastener	WT
	(size)					(lb)
S3106-0000	6"	0.27"	2.29"	1.05"	1/4" Screws	0.42
S3108-0000	8"	0.27"	2.82"	1.34"	1/4" Screws	0.75
S3110-0000	10"	0.32"	3.63"	1.75"	5/16" Screws	1.30
S3112-0000	12"	0.32"	3.93"	1.94"	5/16" Screws	2.28

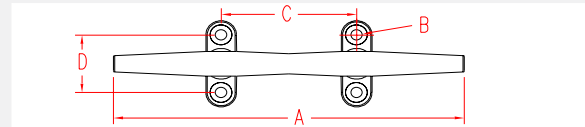

## BLUE WATER CLEAT 316 STAINLESS STEEL



ITEM	A	B	C	D	Fastener	WT
	(size)					(lb)
S3138-0000	8"	0.27"	3.32"	1.78"	1/4" Screws	1.58
S3140-0000	10"	0.32"	3.74"	1.87"	5/16" Screws	2.52
S3142-0000	12"	0.32"	4.78"	2.43"	5/16" Screws	3.78
S3145-0000	15"	0.41"	6.22"	2.53"	3/8" Screws	7.20

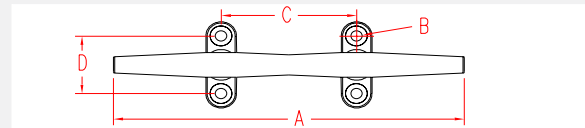

## TRIMLINE CLEAT 316 STAINLESS STEEL



ITEM	A	B	C	D	Fastener	WT
	(size)					(lb)
S3204-0000	4"	0.16"	1.33"	0.80"	1/8" Screws	0.13
S3206-0000	6"	0.26"	2.09"	1.65"	1/4" Screws	0.73
S3208-0000	8"	0.26"	2.65"	1.63"	1/4" Screws	1.00

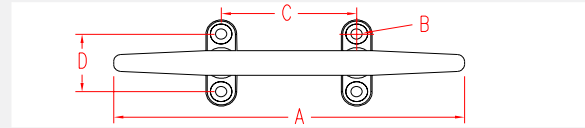

## LIFT EYE CLEAT 316 STAINLESS STEEL

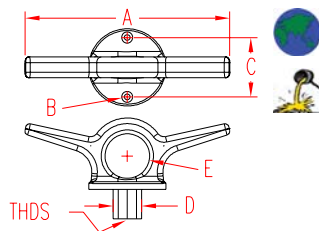

ITEM	SIZE	B	C	D	E	WT
	(length)					(lb)
S3250-0000	7"	0.20"	2.00"	0.98"	1.50"	1.68

**NOTE:**  
USES 2 #10 FASTENERS. THREADS ARE 5/8" - 11 UNC.



TEL 508-732-9191 • FAX 508-732-9798 • ORDERS ONLY 800-394-2222

www.suncorstainless.com

## BOW CHOCKS 316 STAINLESS STEEL



ITEM	SIZE	B	C	FASTENER	WT	ROPE
	(length)				(lb)	(max)
S3304-0000	4"	0.81"	3.13"	# 10 Screws	0.48	5/8"
S3306-0000	6"	0.98"	4.78"	1/4" Screws	1.15	7/8"

**NOTE:**  
SOLD IN SETS: ONE PORT, ONE STARBOARD. EDGES ARE POLISHED AND ROUNDED TO PREVENT CHAFE OF LINES.

## SKENE CHOCKS 316 STAINLESS STEEL



ITEM	SIZE	B	C	FASTENER	WT	ROPE
	(length)				(lb)	(max)
S3340-0000	4"	0.73"	3.37"	#10 Screws	0.52	3/4"
S3360-0000	6"	0.95"	4.69"	1/4" Screws	1.37	1"
S3390-0000	9"	1.72"	7.12"	5/16" Screws	5.69	1-1/4"

**NOTE:**  
SOLD IN SETS: ONE PORT, ONE STARBOARD. EDGES ARE POLISHED AND ROUNDED TO PREVENT CHAFE OF LINES.

## STRAIGHT CHOCK 316 STAINLESS STEEL



ITEM	SIZE	B	C	FASTENER	WT	ROPE
	(length)				(lb)	(max)
S3405-0000	5"	0.93"	4.00"	1/4" Screws	0.35	3/4"
S3406-0000	6"	0.96"	5.12"	1/4" Screws	0.50	1"

**NOTE:**  
SOLD SINGLY. EDGES ARE POLISHED AND ROUNDED TO PREVENT CHAFE OF LINES.

## STEERING WHEEL 316 STAINLESS STEEL

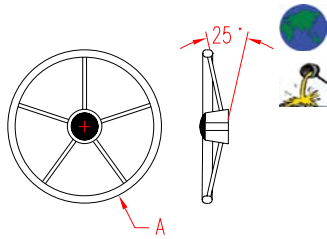
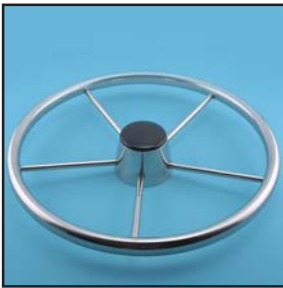

ITEM	A	DEGREE	WT
	(diameter)		(lb)
S3515-2505	15-1/2"	25	5.75

**NOTE:**  
HUB COLOR IS BLACK.  
OTHER VERSIONS ARE AVAILABLE ON SPECIAL ORDER.

## STEERING KNOB 316 STAINLESS STEEL

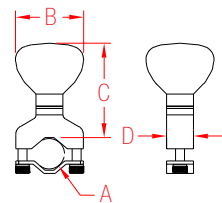

ITEM	A	B	C	D	WT
					(lb)
S3515-0001	3/4"	1.50"	2.25"	N/A	0.43
S3515-0002	3/4"	1.88"	2.70"	0.75"	1.08

**NOTE:**  
OUR STEERING KNOBS ARE DESIGNED TO RETROFIT ONTO STANDARD 3/4" STEERING WHEELS. MADE FROM 316 SS, THESE KNOBS STAND UP TO THE HARSHTEST ELEMENTS WHILE MAINTAINING THEIR POLISHED FINISH.



Key:



Made in USA



Drop Forged



Precision Machined



Wire Formed



Suncor Exclusive



Import



Precision Cast



Stamped



Load Rated



New Product

ORDERS ONLY: 800-394-2222 (USA)  
877-495-5510 (CANADA)

All logos, icons, images, measurements and descriptions are the sole property of Suncor Stainless, Inc. © 2002 Suncor Stainless, Inc.

## ROD HOLDER REMOVABLE 304 STAINLESS STEEL

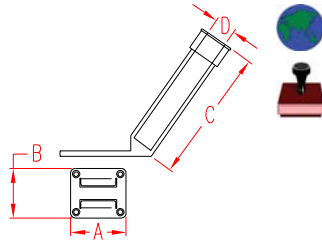

ITEM	SIZE	B	C	D	FASTENER	WT
	(length)					(lb)
S3612-0000	4"	3.65"	10.0"	1.83"	1/4" Screws	1.55

**NOTE:**  
SET INCLUDES ROD HOLDER AND MOUNTING PLATE. IDEAL FOR RETROFITS OR WHERE REMOVAL OF ROD HOLDER IS DESIRABLE.

## HEAVY CAST TOP ROD HOLDER FLUSH MOUNT 316 STAINLESS STEEL

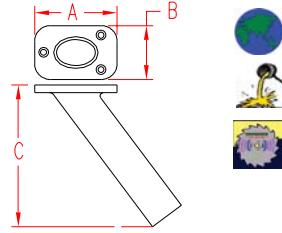

ITEM	A	B	C	DEGREE	FASTENER	WT
	(length)					(lb)
S3611-0000	4-3/8"	3.38"	8.50"	30	1/4" Screws	1.74

**WHITE LINER AND NO CAP**  
S3611-1000

**NOTE:**  
HEAVY DUTY PRECISION CAST HEAD WITH MIRROR FINISH. END OF TUBE IS MACHINED AND DEBURRED.

## ROD HOLDER WITH CAP FLUSH MOUNT 316 STAINLESS STEEL

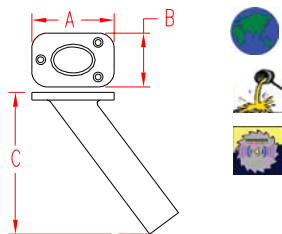

ITEM	A	B	C	DEGREE	FASTENER	WT
	(length)					(lb)
S3611-0001	4-3/8"	3.38"	8.50"	30	1/4" Screws	1.79

**BLACK LINER WITH CAP**  
S3611-1001

**NOTE:**  
HEAVY DUTY PRECISION CAST HEAD WITH MIRROR FINISH. END OF TUBE IS MACHINED AND DEBURRED.

## ANTENNA RATCHET MOUNT 316 STAINLESS STEEL

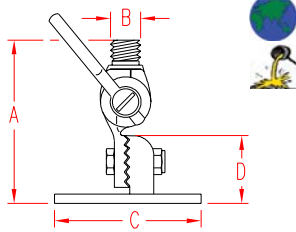

ITEM	A	B	C	D	FAST.	WT
	(size)	(thread)				(lb)
S3620-0000	4-1/2"	1" - 14	3.62"	1.50"	1/4"	1.60
S3621-0000	6"	1" - 14	3.75"	2.30"	1/4"	2.12

**NOTE:**  
HEAVY DUTY ANTENNA RATCHET MOUNT WITH ALL COMPONENTS PRECISION CAST. THREAD "B" FITS STANDARD ANTENNAS.

## ANTENNA RAIL MOUNT 316 STAINLESS STEEL

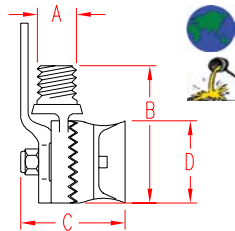

ITEM	SIZE	A	B	C	D	FAST.	WT
	(thread)						(lb)
S3625-0000	#1	1" - 14	3.50"	2.50"	2.00"	1/4"	1.24

**NOTE:**  
HEAVY DUTY ANTENNA RATCHET MOUNT WITH ALL COMPONENTS PRECISION CAST. THREAD "B" FITS STANDARD ANTENNAS.



TEL 508-732-9191 • FAX 508-732-9798 • ORDERS ONLY 800-394-2222

www.suncorstainless.com

## HEAVY DUTY FOLDING STEP 316 STAINLESS STEEL

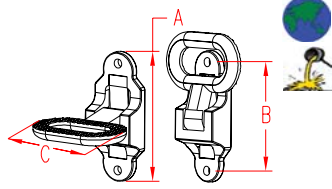

ITEM	A	B	C	FAST.	WT
	(size)				(lb)
S3630-0000	4-3/8"	3.58"	3.33"	5/16"	0.94

**NOTE:**  
USE WHERE TEMPORARY STEP IS REQUIRED. FOLDS UP FLAT WHEN NOT IN USE AND HOLDS EITHER POSITION BY USE OF A LEAF SPRING.

## SKI TOW RING 316 STAINLESS STEEL

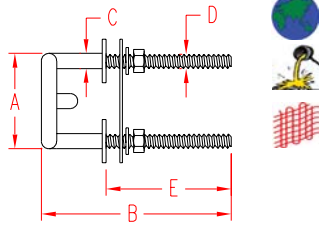

ITEM	A	B	C	D	E	WT
	(size)					(lb)
S3588-0065	2-1/2"	3.94"	0.37"	3/8" - 16	2.38"	0.62
S3588-0075	3"	3.94"	0.37"	3/8" - 16	2.38"	0.67

**NOTE:**  
NUTS AND WASHERS ARE INCLUDED.

## OPEN OAR LOCK 316 STAINLESS STEEL

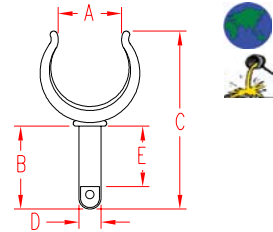

ITEM	A	B	C	D	E	WT
	(diameter)					(lb)
<b>SINGLE</b>						
S3870-0001	1-7/8"	2.00"	4.75"	0.47"	1.50"	0.33
<b>PAIR</b>						
S3870-0002	1-7/8"	2.00"	4.75"	0.47"	1.50"	0.66
<b>OAR LOCK BASE</b>						
S3871-0000						

**NOTE:**  
SOLD SINGLY.  
CHROME AND ZAMAC SOCKET SOLD ON PAGE 135.

## MULTI-TASK DECK KEY 304 STAINLESS STEEL

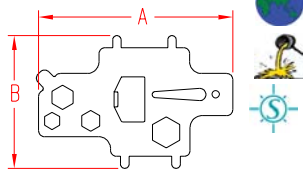

ITEM	A	B	WT
	(size)		(lb)
C3925-0000	4"	2.75"	0.14

**DISPLAY STAND**  
C3925-1000

**NOTE:**  
DECK KEY COMES WITH COLOR LANYARD.  
FITS ALL DECK PLATE CAPS AND COMES WITH BUILT-IN BOTTLE OPENER, SCREW-DRIVER, SHACKLE KEY AND #6, #10, 1/4" AND 3/8" HEX DRIVES.



## FLOOR DRAIN PLATE 304 STAINLESS STEEL

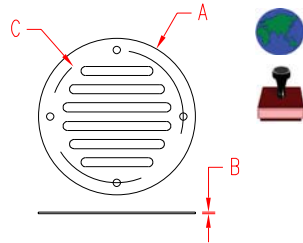
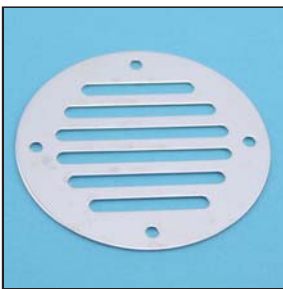

ITEM	A	B	C	D	WT
	(size)				(lb)
S3860-0000	3-1/4"	0.04"	2.75"	0.19	0.07

**NOTE:**  
USE 4 # 8 FASTENERS.



**Key:**

Made in USA	Drop Forged	Precision Machined	Wire Formed	Suncor Exclusive
Import	Precision Cast	Stamped	Load Rated	New Product

ORDERS ONLY: 800-394-2222 (USA)  
877-495-5510 (CANADA)

All logos, icons, images, measurements and descriptions are the sole property of Suncor Stainless, Inc. © 2002 Suncor Stainless, Inc.

## ACCESS HATCH AND FRAME

316 STAINLESS STEEL

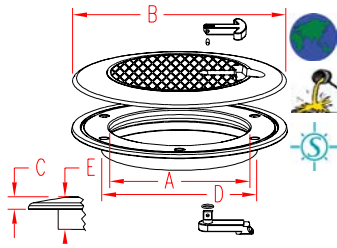

ITEM	A	B	C	D	E	WT
	(size)					(lb)
S3812-0150	6"	9.00"	0.52"	6.50"	1.36"	5.80

**CHEVRON PATTERN. CONVEX, TAPERED RIM.**

**NOTE:**  
HIGHEST QUALITY ACCESS HATCH, FEATURING EXTRA LOW PROFILE, RUBBER GASKET FOR A WEATHER TIGHT SEAL. AND NON-SLIP NON-SKID SURFACE TOP. USE VERTICALLY OR HORIZONTALLY. ENTIRELY REMOVABLE COVER, BOLTS ARE NOT VISIBLE.



## ACCESS HATCH AND FRAME

316 STAINLESS STEEL

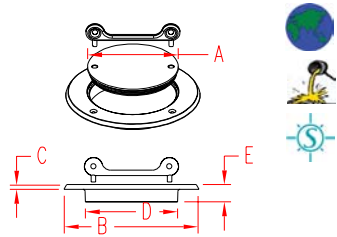

ITEM	A	B	C	D	E	WT
	(size)					(lb)
S3814-0150	6"	9.25"	0.30"	6.38"	1.19"	5.80

**FLUSH MOUNT OR RECESSED. THREADED, ENTIRELY REMOVABLE COVER.**

**NOTE:**  
COMES WITH ACCESS KEY. HIGHEST QUALITY ACCESS HATCH, FEATURING LOW PROFILE, RUBBER GASKET FOR A WEATHER TIGHT SEAL. CAN BE USED VERTICALLY OR HORIZONTALLY.



## CHAIN AND DECK PIPE

316 STAINLESS STEEL

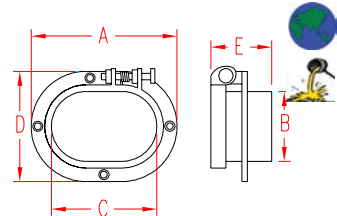

ITEM	A	B	C	D	E	WT
	(size)					(lb)
S3810-0000	5-1/2"	2.71"	3.72"	4.08"	2.00	2.03

**NOTE:**  
USE #10 FASTENERS.  
COVER SLIDES TO OPEN AND IS SPRING LOADED TO CLOSE AUTOMATICALLY.

## ROPE DECK PIPE HINGED

CHROME PLATED BRASS

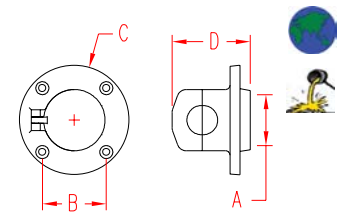

ITEM	A	B	C	D	WT
	(size)				(lb)
C3808-0002	1-1/2"	1.75"	3.00"	2.16"	0.68

**NOTE:**  
PRECISION CAST. USE 3/16" SCREWS.  
HINGED TOP FOR EASY ACCESS.

## ROPE DECK PIPE

CHROME PLATED BRASS

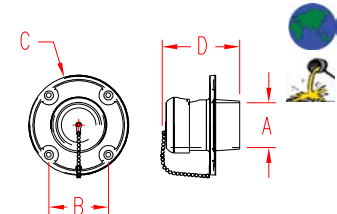

ITEM	A	B	C	D	WT
	(size)				(lb)
C3808-0001	1-3/4"	2.35"	4.00"	2.94"	1.12

**NOTE:**  
PRECISION CAST. USE 3/16" SCREWS.  
SAFETY CHAIN ATTACHED SO TOP IS NOT LOST.



## HAWSE PIPE

316 STAINLESS STEEL

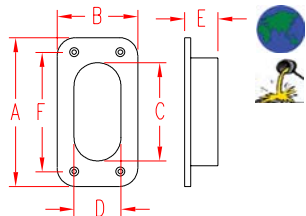

ITEM	A	B	C	D	E	F	WT
	(size)						(lb)
<b>SQUARE</b>							
S3806-0000	6"	3.25"	3.92"	1.88"	1.34"	4.85"	1.38
<b>NOTE:</b> USE #10 FASTENERS.							

## OVAL HAWSE PIPE

316 STAINLESS STEEL

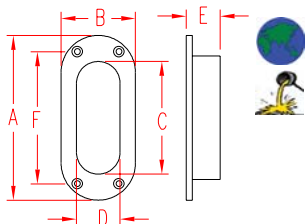

ITEM	A	B	C	D	E	F	WT
	(size)						(lb)
<b>OVAL</b>							
S3806-0001	5-1/2"	2.50"	3.64"	1.45"	1.06"	4.81"	0.85
<b>NOTE:</b> USE #10 FASTENERS.							

## TRIANGULAR HAWSE PIPE

316 STAINLESS STEEL

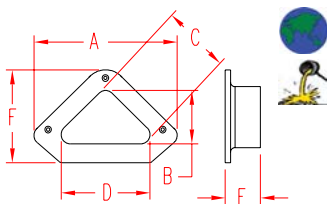

ITEM	A	B	C	D	E	F	WT
	(size)						(lb)
S3807-0000	7-7/8"	2.81"	3.62"	5.00"	1.98"	4.87"	2.60
<b>NOTE:</b> USE #10 FASTENERS.							

## HOSE DECK FILLS

316 STAINLESS STEEL

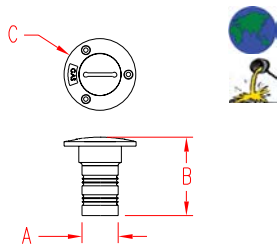

ITEM	A	B	C	TYPE	FAST.	WT	
	(hose)						(lb)
S3911-0000	1-1/2"	3.35"	3.00"	GAS	# 10	1.00	
S3912-0000	1-1/2"	3.35"	3.00"	DIESEL	# 10	1.00	
S3913-0000	1-1/2"	3.35"	3.00"	WATER	# 10	1.00	
S3914-0000	1-1/2"	3.35"	3.00"	WASTE	# 10	1.00	
S3921-0000	2"	3.47"	3.50"	GAS	# 10	1.37	
S3922-0000	2"	3.47"	3.50"	DIESEL	# 10	1.37	
<b>REPLACEMENT CAP</b>							
S3920-0000	1-1/2"						
<b>NOTE:</b> EACH DECK FILL SET INCLUDES BODY, CHAIN, CAP AND KEY EXCEPT THE WASTE SET WHICH DOES NOT INCLUDE CHAIN							

## THRU-HULL HOSE CONNECT

316 STAINLESS STEEL

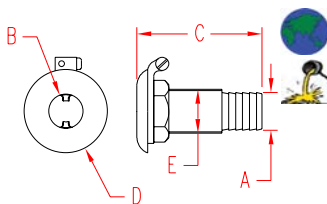

ITEM	A	B	C	D	E	WT	
	(size)					(lb)	
S3815-0020	3/4"	CALL FOR DETAILS AND AVAILABILITY					
S3815-0025	1"	0.75"	2.89"	1.92"	1.03"	0.42	
S3815-0028	1-1/8"	1.00"	3.09"	2.14"	1.30"	0.56	
S3815-0032	1-1/4"	1.12"	3.15"	2.32"	1.49"	0.68	
S3815-0038	1-1/2"	1.33"	3.27"	2.53"	1.63"	0.76	
S3815-0050	2"	1.71"	3.98"	3.32"	2.35"	1.12	
<b>EXTRA LONG</b>							
S3815-EX28	1-1/8"	1.00"	5.50"	2.14"	1.30"	0.82	
<b>NOTE:</b> EACH SET CONTAINS THRU-HULL, WASHER WITH GROUNDING LUG, AND NUT.							



Key:



Made in USA



Drop Forged



Precision Machined



Wire Formed



Suncor Exclusive



Import



Precision Cast



Stamped



Load Rated



New Product

ORDERS ONLY: 800-394-2222 (USA)  
877-495-5510 (CANADA)

All logos, icons, images, measurements and descriptions are the sole property of Suncor Stainless, Inc. © 2002 Suncor Stainless, Inc.